

Bus LCD Keypad  
User Manual

For DS-PK501LTM-HWE:  
EN 50131-3:2009  
EN 50131-1:2006+A1:2009+A2:2017+A3:2020  
Security Grade 2, Environment Class II

User Manual Flow Chart

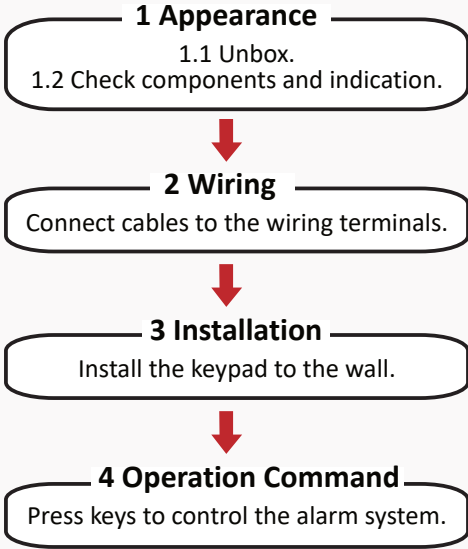

1 Appearance

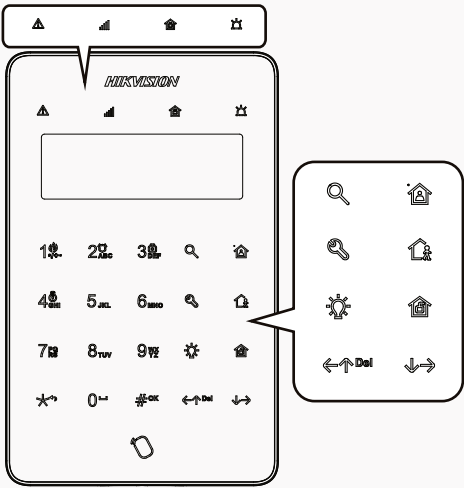

Indicator

Indicator	Indicator Status	Device Status
	Solid orange	Fault
	Off	Normal
	Flashing orange	Pending notifications
	Flashing green	Find me mode
	/	/
	/	/
	Solid blue	All areas armed
	Off	At least one area disarmed
	Solid red	Lid opened alarm
	Flashing red	Zone alarm
	Off	Alarm cleared

Note: When the two alarms of appear at the same time, the lid opened alarm will be displayed first.

Buzzer

Buzzer Indication	Operation
One short beep	Key tone/Swiped tag
Two short beeps	Operation succeeded
Three short beeps	Operation failed
One long beep	New fault
Two long beeps	Installer logged in/Installer logged out (lower volume)
One-time ding-dong	Short doorbell
Repeated sound effects	Fire alarm/Medical alarm/Panic alarm/Long doorbell/Enter delay/Exit delay/Auto arm or disarm

2 Wiring

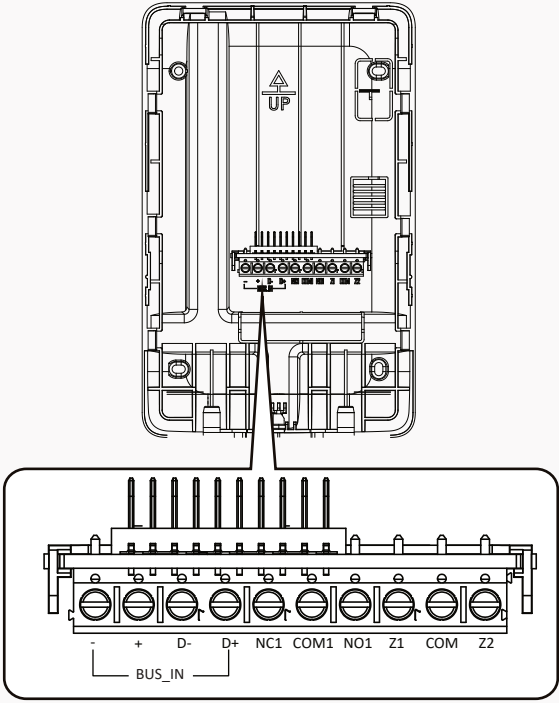

A Keypad Wiring

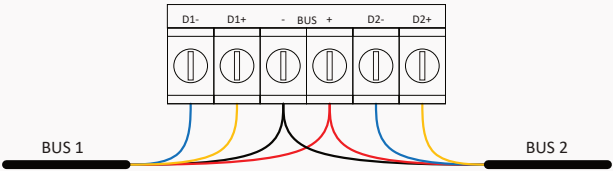

B Zone Wiring Method (EOL=End of Line)

1 Non Resistor Wiring

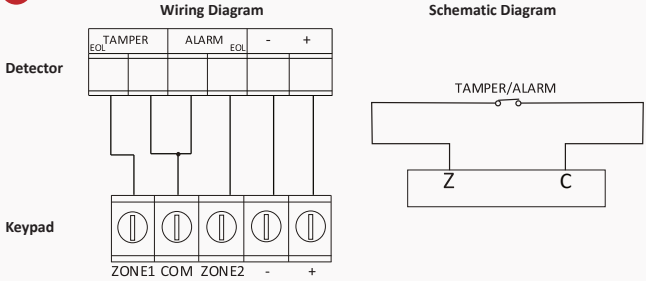

2 Single EOL Wiring

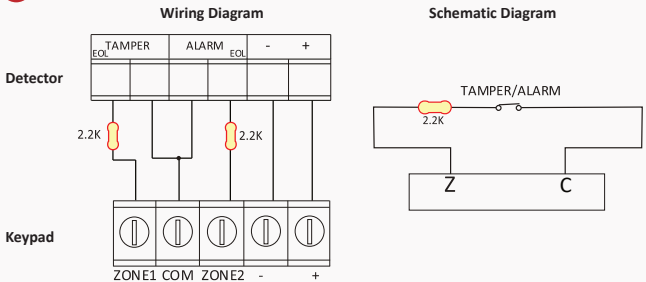

3 Double EOL Wiring

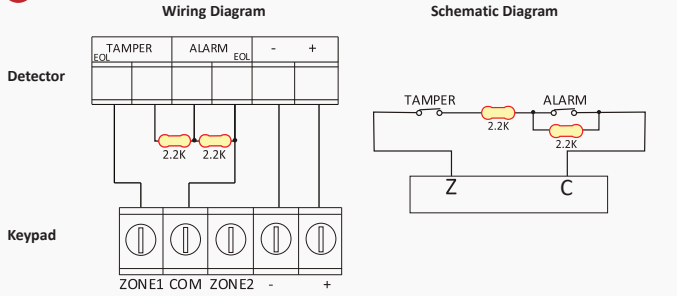

4 Double Zone Wiring

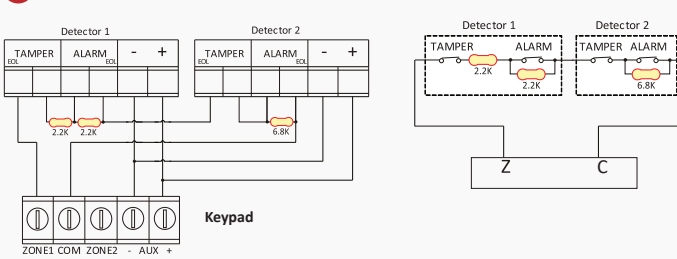

5 Triple EOL Wiring

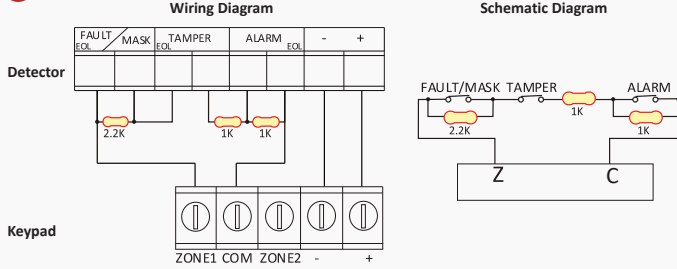

3 Installation

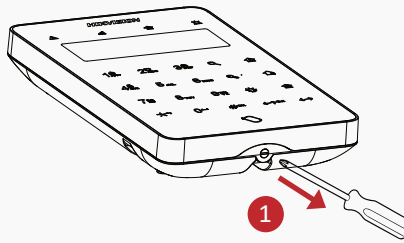

Step 1. Remove the bottom screw.

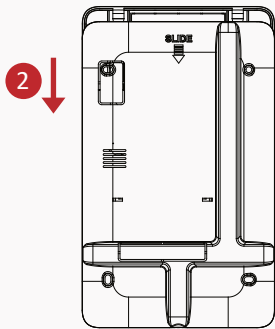

Step 2. Slide the back cover along the arrow direction.

More Languages



UD38408B-A

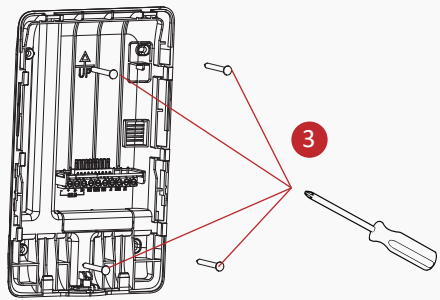

Step 3. Install the rear panel on the wall with 4 screws.

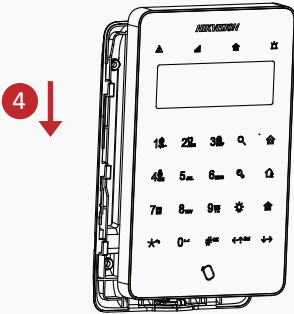

Step 4. Slide the front panel back to the rear panel.

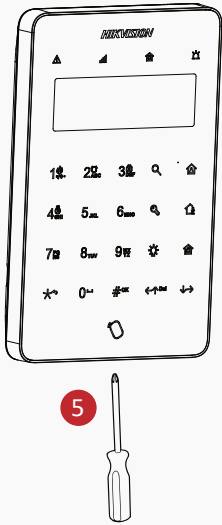

Step 5. Install the screw back to the keypad.

#### 4 Operation Command

Command	Key	Note
Away arm	Password/Tag + ⏏	1. One-push arming does not need to enter the password and supports not to select area No. 2. Use ↓→, ←↑ and # key to select the area number, and press 🔔 to confirm.
Stay arm	Password/Tag + ⏏	
Area away arm	Password/Tag + # + Area No. + ⏏	
Area stay arm	Password/Tag + # + Area No. + ⏏	Note: You need to configure duress password on the control panel WEB client first.
Disarm	Password/Tag + ⏏	
Area disarm	Password/Tag + # + Area No. + ⏏	Use ↓→, ←↑ and # key to select the area number, and press 🔔 to confirm.
Duress password disarm	Duress password + ⏏	
Silence	Password + (hold >3 s) ⏏	
Enter relay selecting page	Password + 🔍	Use ↓→, ←↑ and # key to select the relay number, and press 🔔 to confirm.
Settings	Password + 🔍	Only admin and installer have permission to operate this command.
Query system failure	Password + 🔍	
Fire alarm	(Hold >3 s) 🔍	
Panic alarm	(Hold >3 s) 🔍	
Medical alarm	(Hold >3 s) 🔍	

#### Note:

- Tag here means short swiping (swipe time ≤ 3 s).
- In standard mode, the password operation instructions mentioned above will first display all system faults and all zone faults of the current control panel. You need to confirm faults by the # key, and then perform the function of the next command (except for the query system fault command. After you confirm the fault, the command will end). In simple mode, you do not need to confirm faults.
- Arming process:
  - When the control panel starts the arming process, the keypad supports three stages of the arming process, including arming waiting, fault confirmation, and exit delay.
    - Arming waiting stage: the keypad displays "Arming waiting".
    - Fault confirmation stage: The keypad displays all system faults and operating area zone faults. If it is an away arming operation, confirm with the away arm key; if it is a stay arming operation, confirm with the stay arm key, and use the disarm key to cancel the fault.
    - Exit delay stage: the keypad displays "Exit delay ", and the buzzer counts down.
  - Skip the arming delay through the arm key.Note: For away arming operations, this operation is also away arming; and for stay arming operations, then this operation is also stay arm.
- Cancel the arming through the disarm key.
- Result:
  - Success: The corresponding arming indicator lights for 5 s and then lights off, and the voice prompts the operation is successful.
  - Fail: The corresponding arming indicator does not light up, and the voice prompts that the operation has failed.

#### Specification

Model	DS-PK501LTM-HWE	DS-PK501LTM-HWB
Onboard zones	2	
Onboard outputs	1	
Onboard buzzer	1	
Indicators	4 Status Indicators	
Display	Mono LCD Display	
Tag reader	Support	
Tamper-proof	Front and Rear	
Bus-extender	×	
Interconnection technology (BUS-X)	2-way encrypted communicaiton, half-duplex, asynchronous,	
RF frequency	868.0-868.6 MHz	433.1-433.7 MHz
Power supply	9-16 VDC	
Quiescent current	40 mA @12 VDC	
Maximum current	200 mA @12 VDC	
Interconnection technology (Wireless)	Tri-X, 2-way encrypted wireless, radio frequency hopping	
Transmission modulation	2GFSK	
Operation temperature	-10°C to 40°C (14°F to 104°F)	
Storage temperature	-20°C to 60°C (-4°F to 140°F)	
Relative humidity	10% to 90% noncondensing	
Color	White	
Installation method	Wall mounting	
Dimension (W x H x D)	175 mm × 110 mm × 27 mm	
Weight	301 g	
Electrical conformity	CE, CB	
EN 50131	Security Grade 2, Environmental Class II	

The device is supplied with 12 V power by the AX Hybrid Pro Series control panels (DS-PHA64-LP, DS-PHA48-EP, etc.) of Hikvision, and the auxiliary power output of the control panel complies with LPS.

#### About this Document

- This Document includes instructions for using and managing the Product. Pictures, charts, images and all other information hereinafter are for description and explanation only.
- The information contained in the Document is subject to change, without notice, due to firmware updates or other reasons. Please find the latest version of the Document at the Hikvision website (<https://www.hikvision.com>). Unless otherwise agreed, Hangzhou Hikvision Digital Technology Co., Ltd. or its affiliates (hereinafter referred to as "Hikvision") makes no warranties, express or implied.
- Please use the Document with the guidance and assistance of professionals trained in supporting the Product.

#### About this Product

This product can only enjoy the after-sales service support in the country or region where the purchase is made.

#### Acknowledgment of Intellectual Property Rights

- Hikvision owns the copyrights and/or patents related to the technology embodied in the Products described in this Document, which may include licenses obtained from third parties.
- Any part of the Document, including text, pictures, graphics, etc., belongs to Hikvision. No part of this Document may be excerpted, copied, translated, or modified in whole or in part by any means without written permission.
- HIKVISION** and other Hikvision's trademarks and logos are the properties of Hikvision in various jurisdictions.
- Other trademarks and logos mentioned are the properties of their respective owners.

#### LEGAL DISCLAIMER

- TO THE MAXIMUM EXTENT PERMITTED BY APPLICABLE LAW, THIS DOCUMENT AND THE PRODUCT DESCRIBED, WITH ITS HARDWARE, SOFTWARE AND FIRMWARE, ARE PROVIDED "AS IS" AND "WITH ALL FAULTS AND ERRORS". HIKVISION MAKES NO WARRANTIES, EXPRESS OR IMPLIED, INCLUDING WITHOUT LIMITATION, MERCHANTABILITY, SATISFACTORY QUALITY, OR FITNESS FOR A PARTICULAR PURPOSE. THE USE OF THE PRODUCT BY YOU IS AT YOUR OWN RISK. IN NO EVENT WILL HIKVISION BE LIABLE TO YOU FOR ANY SPECIAL, CONSEQUENTIAL, INCIDENTAL, OR INDIRECT DAMAGES, INCLUDING, AMONG OTHERS, DAMAGES FOR LOSS OF BUSINESS PROFITS, BUSINESS INTERRUPTION, OR LOSS OF DATA, CORRUPTION OF SYSTEMS, OR LOSS OF DOCUMENTATION, WHETHER BASED ON BREACH OF CONTRACT, TORT (INCLUDING NEGLIGENCE), PRODUCT LIABILITY, OR OTHERWISE, IN CONNECTION WITH THE USE OF THE PRODUCT, EVEN IF HIKVISION HAS BEEN ADVISED OF THE POSSIBILITY OF SUCH DAMAGES OR LOSS.
- YOU ACKNOWLEDGE THAT THE NATURE OF THE INTERNET PROVIDES FOR INHERENT SECURITY RISKS, AND HIKVISION SHALL NOT TAKE ANY RESPONSIBILITIES FOR ABNORMAL OPERATION, PRIVACY LEAKAGE OR OTHER DAMAGES RESULTING FROM CYBER-ATTACK, HACKER ATTACK, VIRUS INFECTION, OR OTHER INTERNET SECURITY RISKS; HOWEVER, HIKVISION WILL PROVIDE TIMELY TECHNICAL SUPPORT IF REQUIRED.
- YOU AGREE TO USE THIS PRODUCT IN COMPLIANCE WITH ALL APPLICABLE LAWS, AND YOU ARE SOLELY RESPONSIBLE FOR ENSURING THAT YOUR USE CONFORMS TO THE APPLICABLE LAW. ESPECIALLY, YOU ARE RESPONSIBLE, FOR USING THIS PRODUCT IN A MANNER THAT DOES NOT INFRINGE ON THE RIGHTS OF THIRD PARTIES, INCLUDING WITHOUT LIMITATION, RIGHTS OF PUBLICITY, INTELLECTUAL PROPERTY RIGHTS, OR DATA PROTECTION AND OTHER PRIVACY RIGHTS. YOU SHALL NOT USE THIS PRODUCT FOR ANY PROHIBITED END-USES, INCLUDING THE DEVELOPMENT OR PRODUCTION OF WEAPONS OF MASS DESTRUCTION, THE DEVELOPMENT OR PRODUCTION OF CHEMICAL OR BIOLOGICAL WEAPONS, ANY ACTIVITIES IN THE CONTEXT RELATED TO ANY NUCLEAR EXPLOSIVE OR UNSAFE NUCLEAR FUEL-CYCLE, OR IN SUPPORT OF HUMAN RIGHTS ABUSES.
- IN THE EVENT OF ANY CONFLICTS BETWEEN THIS DOCUMENT AND THE APPLICABLE LAW, THE LATTER PREVAILS.

© Hangzhou Hikvision Digital Technology Co., Ltd. All rights reserved.